

Contractor shall check all dimensions on the work and report any discrepancy to the Landscape Architect before proceeding. All drawings and specifications are the property of the Landscape Architect and must be returned at the completion of the work. This drawing is not to be used for construction until signed by the Landscape Architect.

No.	Description	Date
1.	ISSUED FOR CO-ORDINATION	MAY.25.04

Revision

NAK
design group

Landscape Architecture
Urban Design
Community Planning

355 Adelaide Street W.
Studio 400 Toronto
Ontario M5V 1S2
tel: 416.340.8100
fax: 416.340.7100
nak@nak-design.com

Project

PALTER RESIDENCE

37 MISTY CRESCENT
NORTH YORK, ONTARIO
CANADA

Title

LANDSCAPE PLAN

Date	MAY 2004	Sheet
Scale	1:100	
Drawn	SY	
Checked	RN	
Job No.	304025	

L1

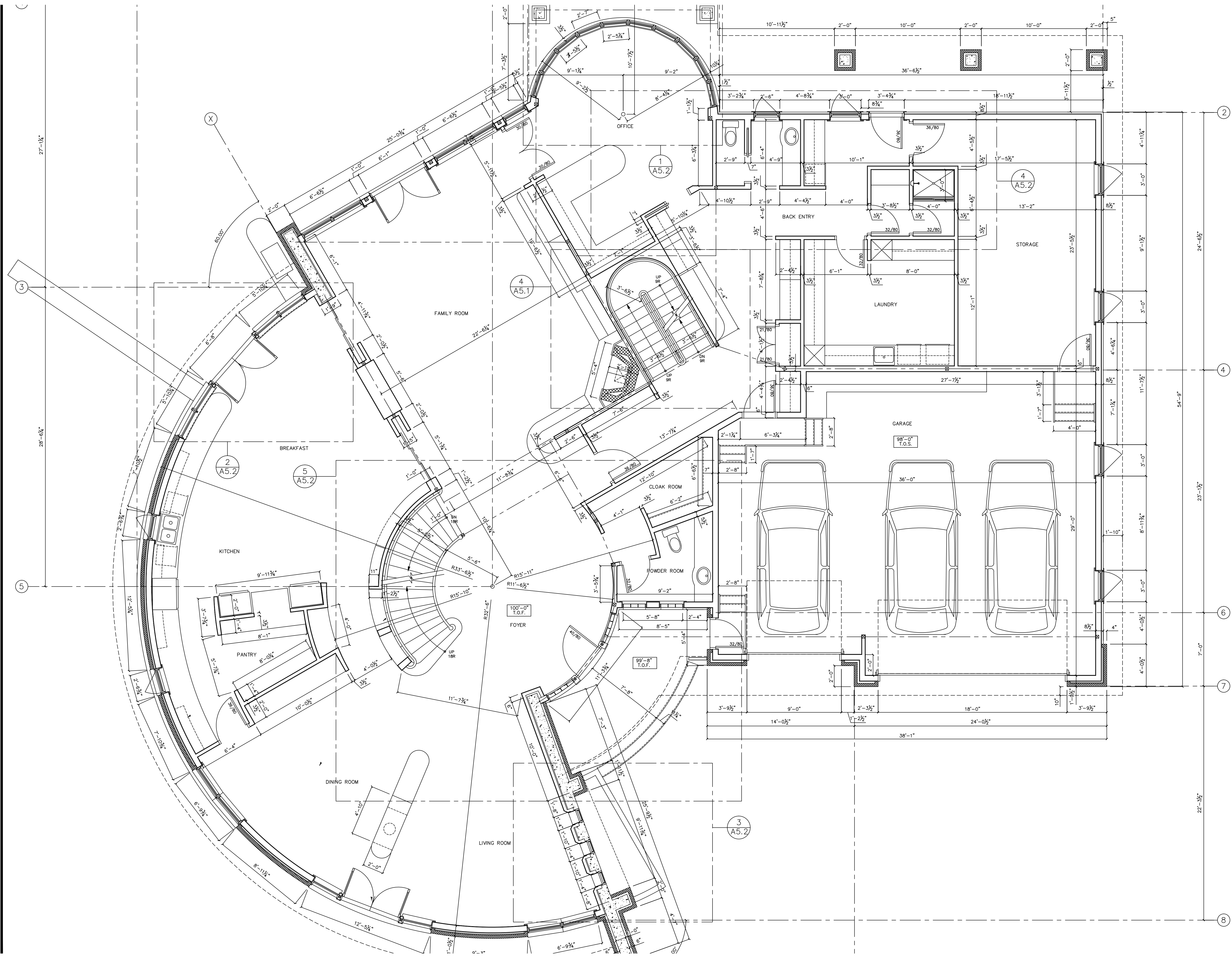
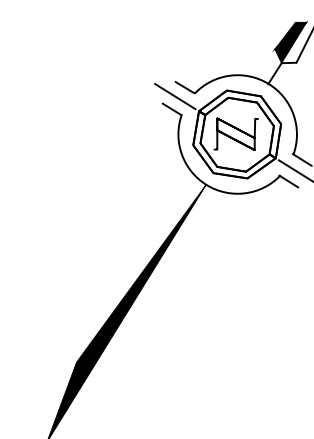

No.	Date	Revision / Issue	Initial
2	30/June/04	Building Permit, Tender & Construction Issue	KBB
1	15/June/04	Client & Consultant Reviews Issue	KBB
0	20/May/04	Client & Consultant Reviews Issue	KBB

Do not scale the drawings, use the dimensions indicated. Contractor to confirm conditions and dimensions on site, and report any discrepancies to the Architect for directions.
 Plans and specifications are the property of the Architect, and must be returned at completion of the Work. Do not use the drawings and specifications for any other purpose, project or location.
 Reference all drawings and specifications from all Project Consultants. Each forms an integral part of the Construction Documents. Contractor to report any discrepancies between Consultant documents to the Architect for directions.
 The drawings shall not be used for Construction purposes unless sealed and signed by the Architect.

COLUMBINE STUDIOS
 Architect + Interiors

46 Columbine Avenue
 Toronto Ontario
 CANADA M4L 1P5

T: (416) 694-9630
 F: (416) 694-4269
 E: columbinestudios@sympatico.ca

PERMIT & CONSTRUCTION

Drawing bases and project design by Solomon Design Group.
 Technical services by Columbine Studios Architect.

Client Elisa and Gil Palter		
Project PALTER RESIDENCE 37 MISTY CRESCENT		
North York Ontario Canada		
Date 30/June/04	Drawn KBB / RK	Checked KBB
Drawing Title FIRST FLOOR PLAN		

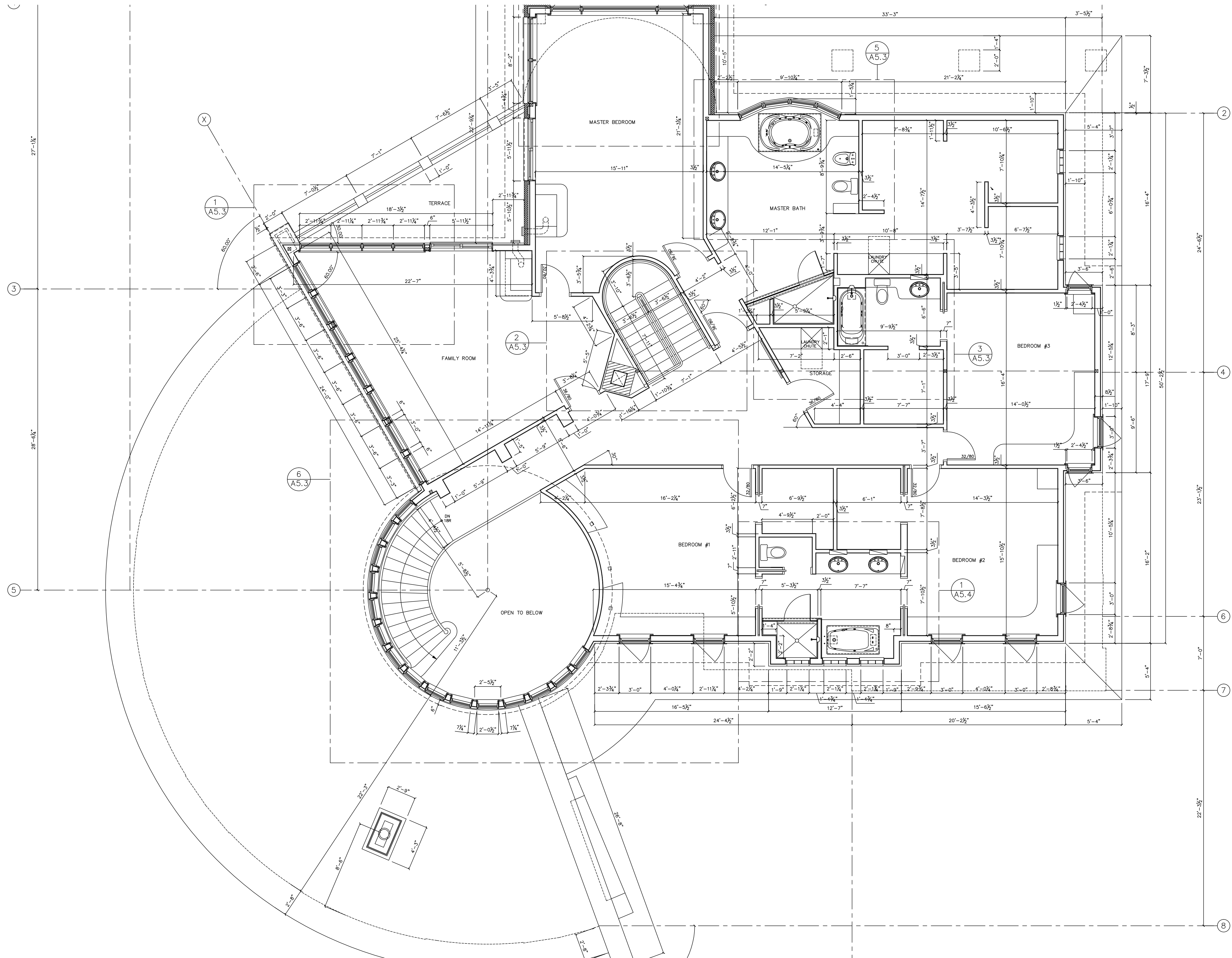
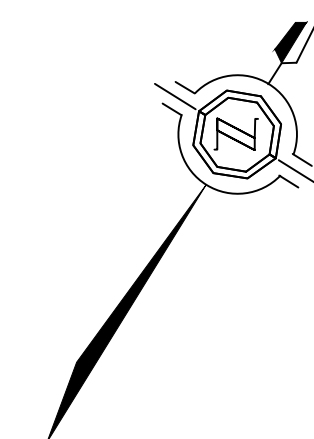

No.	Date	Revision / Issue	Initial
2	30/June/04	Building Permit, Tender & Construction Issue	KBB
1	15/June/04	Client & Consultant Reviews Issue	KBB
0	20/May/04	Client & Consultant Reviews Issue	KBB

Do not scale the drawings, use the dimensions indicated. Contractor to confirm conditions and dimensions on site, and report any discrepancies to the Architect for directions.
 Plans and specifications are the property of the Architect, and must be returned at completion of the Work. Do not use the drawings and specifications for any other purpose, project or location.
 Reference all drawings and specifications from all Project Consultants. Each forms an integral part of the Construction Documents. Contractor to report any discrepancies between Consultant documents to the Architect for directions.
 The drawings shall not be used for Construction purposes unless sealed and signed by the Architect.

COLUMBINE STUDIOS
 Architect + Interiors

46 Columbine Avenue
 Toronto Ontario
 CANADA M4L 1P5

T: (416) 694-9630
 F: (416) 694-4269
 E: columbinestudios@sympatico.ca

PERMIT & CONSTRUCTION

Drawing bases and project design by Solomon Design Group. Technical services by Columbine Studios Architect.

Client Elisa and Gil Palter		
Project PALTER RESIDENCE 37 MISTY CRESCENT		
North York Ontario Canada		
Date 30/June/04	Drawn KBB / RK	Checked KBB
Drawing Title SECOND FLOOR PLAN		

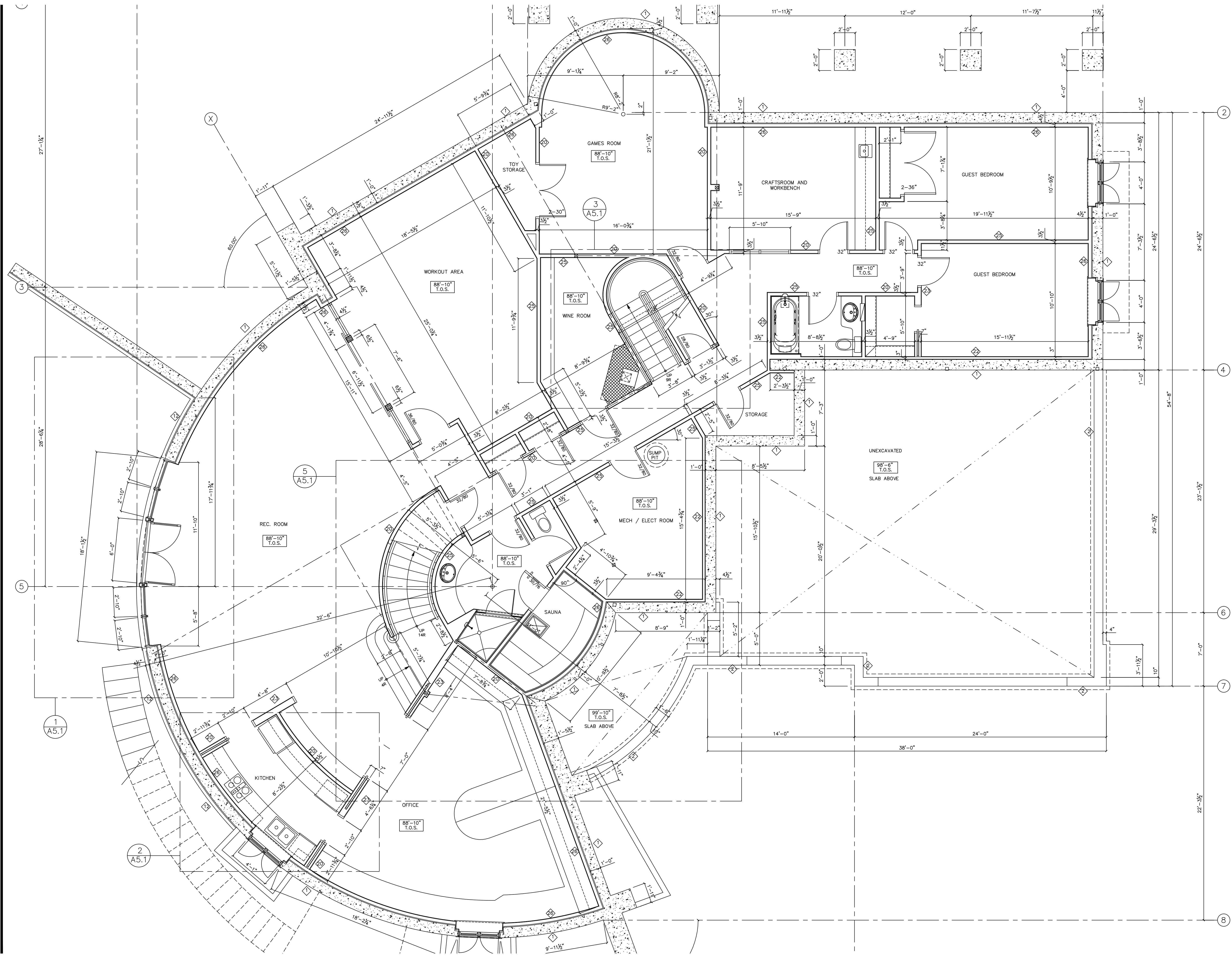
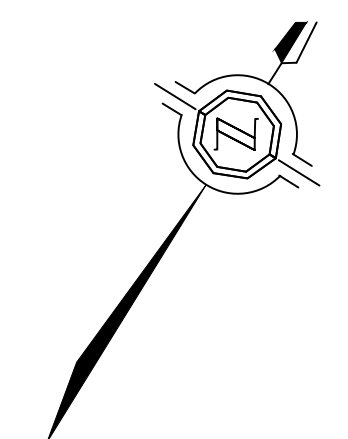

No.	Date	Revision / Issue	Initial
2	30/June/04	Building Permit, Tender & Construction Issue	KBB
1	15/June/04	Client & Consultant Reviews Issue	KBB
0	20/May/04	Client & Consultant Reviews Issue	KBB

Do not scale the drawings, use the dimensions indicated. Contractor to confirm conditions and dimensions on site, and report any discrepancies to the Architect for directions.
 Plans and specifications are the property of the Architect, and must be returned at completion of the Work. Do not use the drawings and specifications for any other purpose, project or location.
 Reference all drawings and specifications from all Project Consultants. Each forms an integral part of the Construction Documents. Contractor to report any discrepancies between Consultant documents to the Architect for directions.
 The drawings shall not be used for Construction purposes unless sealed and signed by the Architect.

COLUMBINE STUDIOS
 Architect + Interiors

46 Columbine Avenue
 Toronto Ontario
 CANADA M4L 1P5

T: (416) 694-9630
 F: (416) 694-4269
 E: columbinestudios@sympatico.ca

PERMIT & CONSTRUCTION

Drawing bases and project design by Solomon Design Group.
 Technical services by Columbine Studios Architect.

Client Elisa and Gil Palter		
Project PALTER RESIDENCE 37 MISTY CRESCENT North York Ontario Canada		
Date 30/June/04	Drawn KBB / RK	Checked KBB
Drawing Title BASEMENT FLOOR PLAN		